

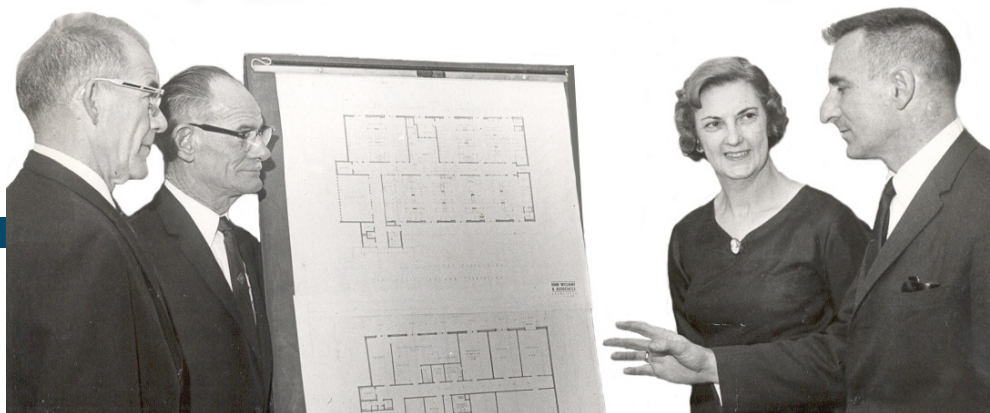

Empowering All Abilities

# Building on a *Legacy* CAMPAIGN

Ensuring Brighter Futures



# OUR MISSION

Because we believe life is sacred,  
Hattie Larlham enhances the quality of life for  
people with intellectual and developmental  
disabilities and their families through our  
commitment to comfort, joy and achievement.



— 60+ YEARS OF PROGRESS —

## THE HATTIE LARLHAM DIFFERENCE

*An inclusive approach to ID/DD care*

With a holistic, inclusive approach to health and wellbeing, we bring compassion, respect, and dedication to the thoughtful care we provide and, in doing so, we support and empower families to thrive in ways that would otherwise be impossible.



**Watch us in action!**





Adult Day Support  
& Recreation

Residential  
Support

Center  
for Children

Employment  
Services

Dahlberg Gibson  
Learning Center

# IMPACT STATEWIDE

PROGRAMS & SERVICES



**COUNTLESS** Opportunities

**1,600+** people served

**11** counties served



**WE ARE HATTIE LARLHAM**

# A LEGACY

*Where it all started*

**The Hattie Larlham Center for Children with Disabilities** is so much more than a long-term care facility. For 63 years, we have been a beacon of hope for families experiencing the challenges of providing care to their loved ones with intellectual and developmental disabilities. At the Center, countless families have found exceptional comfort in the assurance that their loved ones will thrive in an environment designed specifically to support their complex needs. The Center is one of the most expansive providers of ICF care in Ohio and we remain committed to setting the standard of care in our industry.



In 1961, Hattie Larlham made the impossible possible. What began with one woman, one child, and one vision for a better, brighter future has flourished as an organization that now serves more than 1,600 families annually.

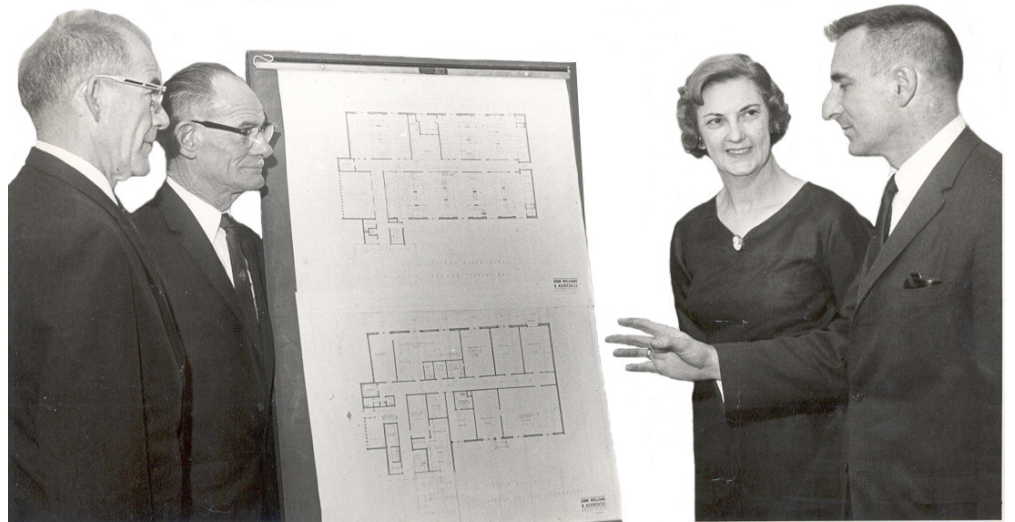



# VISION FOR THE FUTURE

## *Laying foundations for tomorrow*

The next chapter of our legacy is dedicated to realizing a new vision for brighter futures. To bring this vision to life, Hattie Larlham has endeavored to raise \$17.2M to support a comprehensive addition and renovation project at our Center for Children with Disabilities.

The project has been thoughtfully and strategically planned to enhance our facility in three major areas.

### **We will focus on...**

1. **Building a home** that is comfortable and dignified for every resident;
2. **Raising the bar** for the standard of respiratory care provided for ventilator dependent residents;
3. And **cultivating excellence** within our staff by offering a modernized work environment that optimizes our capacity to provide the best possible care to our residents.

The **Building on a Legacy** capital campaign is an opportunity to honor our commitment to excellence and, with your support, imagine even brighter futures for the children and adults who rely on us.



**Currently, the Center is 118,902 square feet, of which 60,181 square feet is residential. This capital campaign will add 10,051 square feet of residential space, making our residential areas more than 59% of our overall footprint- an unheard of ratio among ICF and long-term care facilities.**

# VENTILATOR PROGRAM ADDITION

*Raising the bar in respiratory care*



**Project Cost**  
\$6,500,000

**Square Footage**  
10,051

Hattie Larlham is a leading provider of services to individuals who are ventilator-dependent and reside in an ICF in the state of Ohio. To elevate our standard of care, we will construct an addition to the Center that is focused on our ventilator program, utilizing state-of-the-art equipment and technology that offers the best possible support for the unique needs of the residents who rely on intensive, round-the-clock respiratory therapy services.

## Features:

- Entire new building addition
- 14 new semi-private rooms
- Room layouts custom designed to support needs of ventilator-dependent residents
- Central nurse hub
- Expanded common living space to accommodate mobile medical equipment without compromising space for recreation and socialization



Tree units in common living areas bring life and vibrancy to shared spaces while also serving a critical purpose. Each unit contains necessary equipment and ports for oxygen, power, suction and medical air for residents to have more mobility through the space.



## Resident rooms include:

- A 20% increase in area to better accommodate staff and caregivers
- Infrastructural placement of equipment for optimized caregiver comfort and efficiency while supporting ventilator-dependent residents
- Warm, wood tone finishes to enhance the homey feel



# HELPING STAFF & CULTIVATING EXCELLENCE

Hattie Larlham employees make a life-changing impact every day. To support them in doing their best work, we will revise and update the existing floor plan and interior finishes at the Center. These changes will optimize the work environment for our employees, making it easier to efficiently deliver the quality of care and support each resident deserves.

Modernized nursing station that provides the best tools to monitor and maintain high-quality care for residents.



1

2

3



## Nurses station improvements include:

- Central work areas to facilitate team collaboration and improved workflows
- Individual charting stations adjacent to team area
- Optimally positioned patient monitoring systems
- Staff amenities like water bottle fillers, storage cubbies, and new seating
- Readily available hand wash stations placed for ease of access

## Additional plans for common living areas:

- Lighting that is adjustable in color temperature and brightness to allow for variation in season and time of day
- Full color murals which enliven spaces with comforting and welcoming depictions of nature
- Warm color palates that enhance the feeling of home and minimize the attributes of a clinical setting

## Naming Opportunities

1. Ventilator Program Addition Building Name
2. Nurse Station/Hub
3. Common Living Area



# CENTER COMMUNITY

*Designed for connection*



**Project Cost**  
\$750,000

**Square Footage**  
4,000

## Features:

- Centralized Therapy Services Hub
- Maximized space for staff to deliver therapies
- Furnished occupational therapy skills lab
- More space for equipment storage
- Mobility Service Center
- A dedicated Snoezelen Room for sensory-related therapy

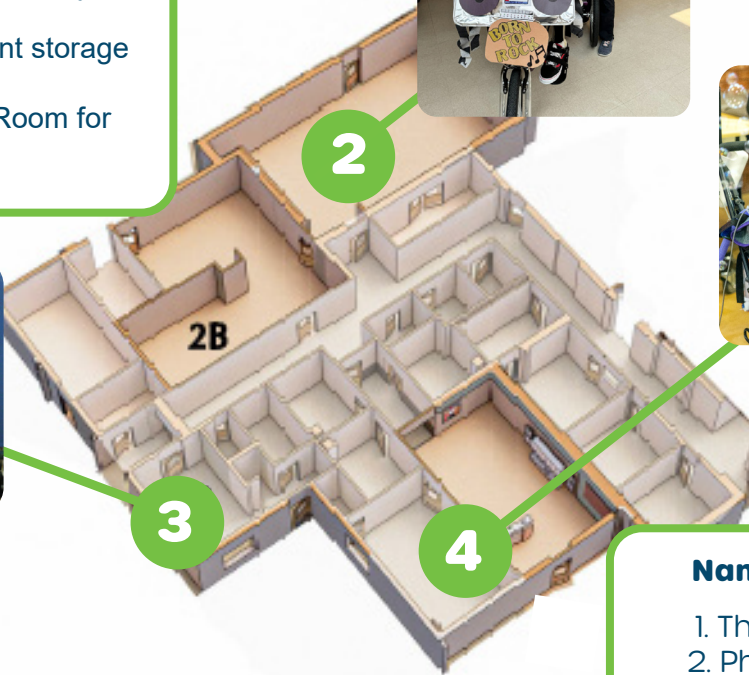

## Naming Opportunities

1. Therapy Services Hub
2. Physical Therapy Gym
3. Mobility Service Center
4. Snoezelen Sensory Room

## Project Includes:

- Expansion of current physical therapy gym to optimize space for resident therapies
- Reconfigured staff workstation and team areas to further enhance collaboration between team members
- Streamlined storage areas to allow for additional treatment space within the current gym
- Adjustment of doorways to provide easier access for staff and residents into the PT area
- Former administrative office areas renovated to create an enlarged, dedicated sensory Snoezelen Room and occupational therapy activity space



# ARTS & RECREATION CENTER

For the first time, we are able to centralize and unify all of our art and enrichment programs in one location and provide more access to outdoor experiences. The increased space will allow more community classes in art, music, and more.



**Project Cost**  
\$2,750,000

**Square Footage**  
6,500



CREATIVE ARTS & RECREATIONAL SERVICES

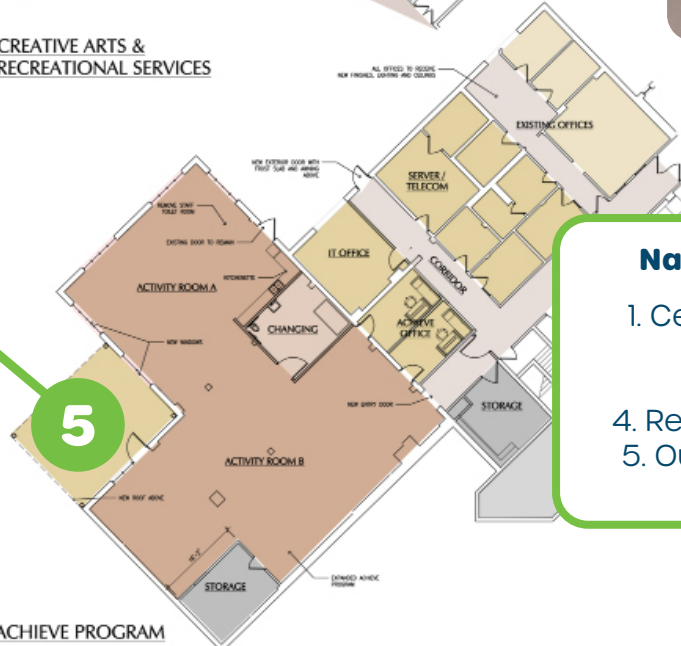

ACHIEVE PROGRAM

## Naming Opportunities

1. Center for Achievement
2. Art Studio
3. Music Studio
4. Recreation Activity Room
5. Outdoor Patio & Garden

1

## Project Includes:

- Expansion of current art studio for increased usable space
- Expansion of recreation space by 50% and development of attached storage for supplies
- All rooms will have windows and daylighting where previously there was no natural light
- Dedicated work area for art activity leaders that is separate from but adjacent to the art studio
- All new finishes that provide modernized appearance and while allowing for ease of maintenance
- Reconfigured storage and service areas to enable staff to better serve residents
- Direct access to a covered outdoor patio area for residents to enjoy outdoor experiences

# BUILDING A HOME

*Ensuring beautiful spaces*



We invite you to envision a home designed to embrace the dignity and person hood of every resident. A home that complements state-of-the-art medical equipment and the comfort of modern amenities with educational, recreational, daily care, and therapeutic programs designed to foster health, happiness, and achievement.

**Costs**  
\$5,100,000

**Square footage**  
60,181

## Features:

- 65 new energy efficient windows
- Refreshed paint to modernize residential and communal spaces and eliminate dated, clinical feel
- New scenic murals for additional color and atmosphere
- New specialty flooring to improve safety for wheelchairs high foot traffic
- Wall and floor finishings that reduce involved maintenance and increase durability
- HVAC system for enhanced air quality and zoned temperature control

## Project Includes:

- All wall and floor finishes are being replaced throughout.
- Replacement of all HVAC equipment as it is nearing the end of its useful life.
- Removal and replacement of wall protection throughout the facility.
- Replacement of 65 windows that have not previously been replaced, as well as select entry and exit doors.
- Replacement of medical air and vacuum systems equipment
- Replacement of select boilers as they are at the end of their useful life.
- Upgrade of building wide HVAC control systems.
- Creation of dedicated dietary rooms in each living suite.
- Nursing station upgrades are occurring in all living suites to better accommodate the needs of staff and to support efficient care delivery and collaboration among team members.
- Select living areas are being expanded to allow for additional common living space in Reflection Pond, Whispering Meadows and Cascade Falls.



# BRINGING THE OUTSIDE IN

A home should never feel clinical and sterile. The renovation project ensures comfortable, inviting, and dignified spaces for all 124 Center residents to live, play, and thrive.

1

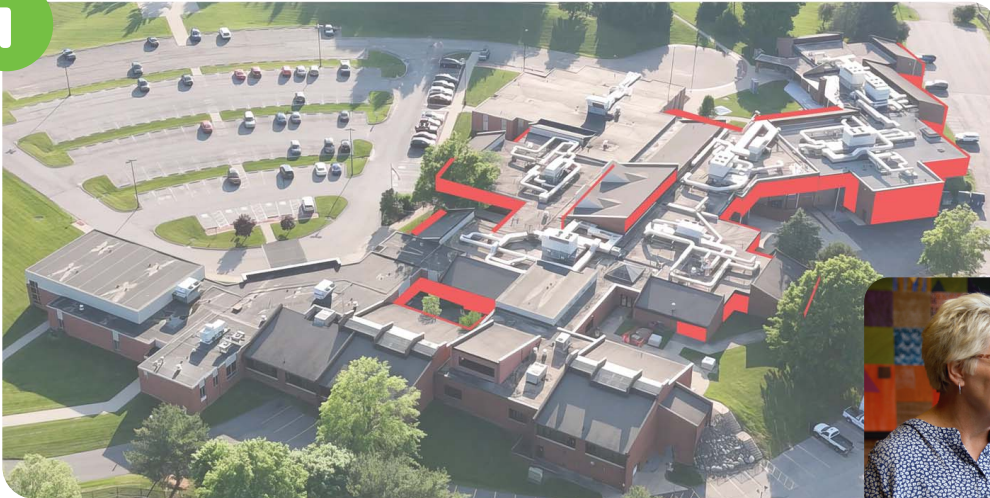

More than 50% of the Center's windows need replaced. New windows will provide more spaces with views outside and natural lighting, critical for optimal physical and mental health. .



Adding color and a touch of nature, new scenic murals will be placed throughout the Center.



2



## Naming Opportunities

1. New Windows
2. Art Murals
3. Flooring

In all living suites, we are creating dedicated dietary rooms. Each dietary rooms includes a sink, base, and wall cabinets for storage, counters for meal prep and allocated space for refrigerator units. In creating these, we are freeing up area within the common areas of each living suite. By enclosing the rooms, we are making the common areas more visually appealing to residents and creating a dedicated area where staff have all of the necessary supplies and articles at hand for resident meals.

Home improvements are an investment in the future. By carefully considering longevity and future needs, the Center's renovation efforts have been thoughtfully developed to insure that these changes will set us up for success for the next 20 or more years. Our residents and staff are our top priority and, with your support, we can continue a legacy that shines bright.

# SECURING OUR LEGACY

*Empowering All Abilities, Together.*

The Center for Children established us as a leading provider in the state and allowed us to grow and achieve more. Improving the Center sets us up for decades to come and fortifies our legacy as we continue to envision a brighter future.

## A BRIGHT GOAL

### Seeking \$17.2 Million

We are committed to ensuring that every dollar donated to this campaign is used wisely and effectively. In addition to the costs outlined here, a 10.5% contingency is built into our goal so that we are able to address any unforeseen obstacles without interruption during the project.

Our board of directors, executive team, and staff are fully dedicated to the success of this project and will oversee its implementation with transparency and accountability.

With your support, we can make this vision a reality. The Hattie Larlham legacy is defined by our commitment to a high standard of excellence and as we enter this new chapter, we look forward to embracing new opportunities to shine our brightest. Together, we can continue a legacy; caring for and empowering individuals with intellectual and developmental disabilities to live their best lives. Your support of our capital campaign will not only transform the bricks and mortar of our building but the lives of those we serve daily.

#### Campaign Committee Members

**Co-Chairpersons: Lora Lewis | Jeff Knox | Christine Callahan | Larry Callahan**

Joey Arnold | Diane Foley | Dan Glessner | Dr. Richard Grossberg | Dr. Christina Hardesty | Bruce Hearey  
Putter Johnson | Lou Joseph | Ron Kotkowski | Alisa Lassiter | Stan Majkrzak | Susan Racey  
Mike Rapaport | Sandee Reid | Tina Sanzone | Adrienne Vichill | Mike Weinhardt

#### Hattie Larlham Staff Committee Members

Stephen Colecchi | Mary Horoszko | John Keverkamp | Sandy Cinch | Shannan Ritchie | Audrey Arend | Joe Prada

##### MARY HOROSZKO

Chief Development Officer  
330-840-6840

[mary.horoszko@hattielarlham.org](mailto:mary.horoszko@hattielarlham.org)

##### STEPHEN COLECCHI

Chief Executive Officer  
330-840-6838

[stephen.colecchi@hattielarlham.org](mailto:stephen.colecchi@hattielarlham.org)



Empowering All Abilities